

GENERAL NOTES  
 1. All work under this plan shall be in conformity with applicable provisions of Standard Specifications No. 222, 223, 224, 225, 226, 227 and Standard Drawing No. 222, as filed in the Office of the City Engineer.  
 2. Bench Mark  
 Center Line of Mill St. and Arrowhead Ave.  
 E.L. 997.55 M.S.L.

APPROVED	DATE	1942
REGISTERED CIVIL ENGINEER NO. 42551		
DRAWING NO. 3309	DRAWN BY	
SHEET 1 OF 1	CHECKED BY	
1 SHEET	RECOMMENDED BY	
CITY OF SAN BERNARDINO DEPARTMENT OF ENGINEERING IMPROVEMENT PLAN Northeast Corner of Mill St. and Arrowhead Ave.		

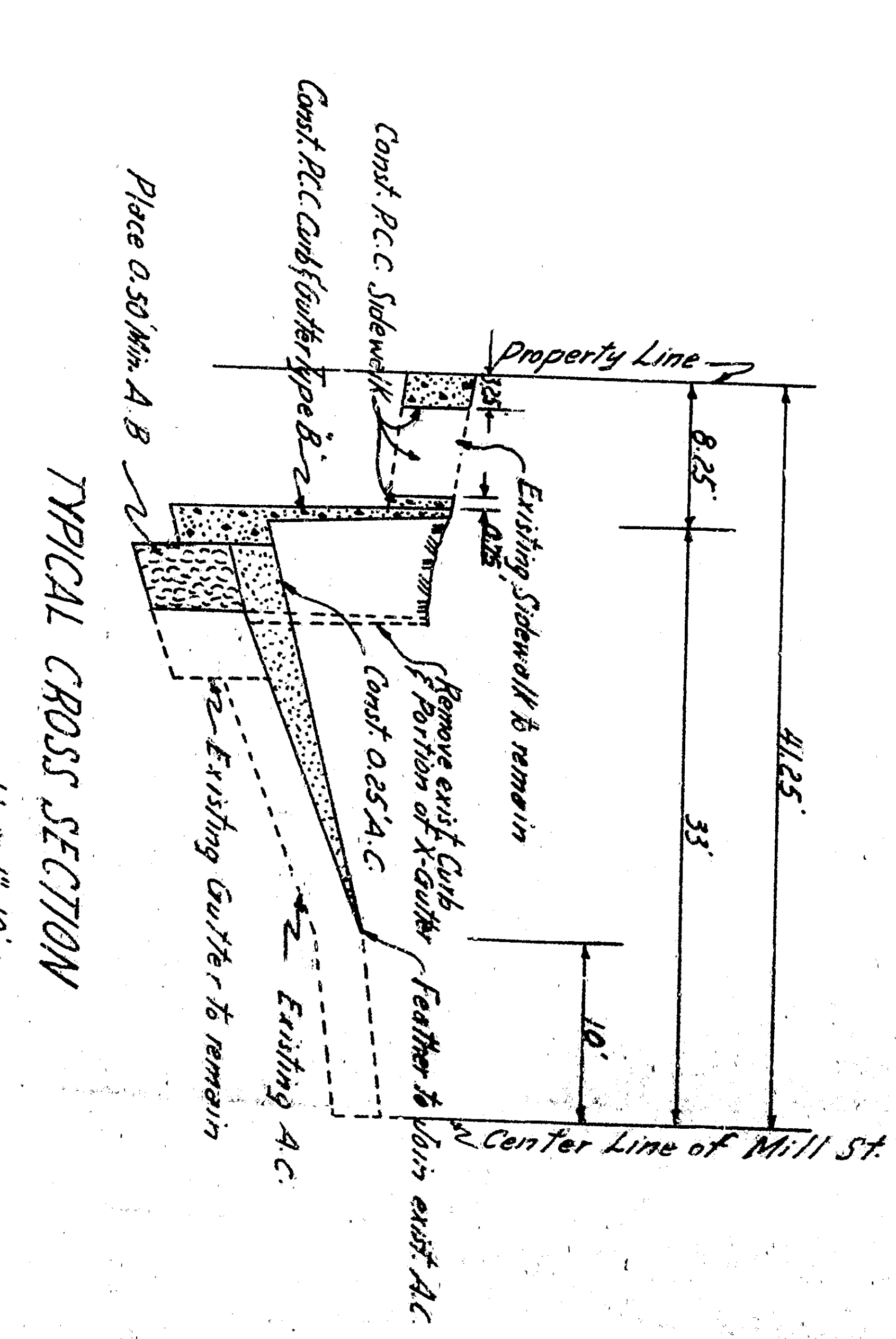

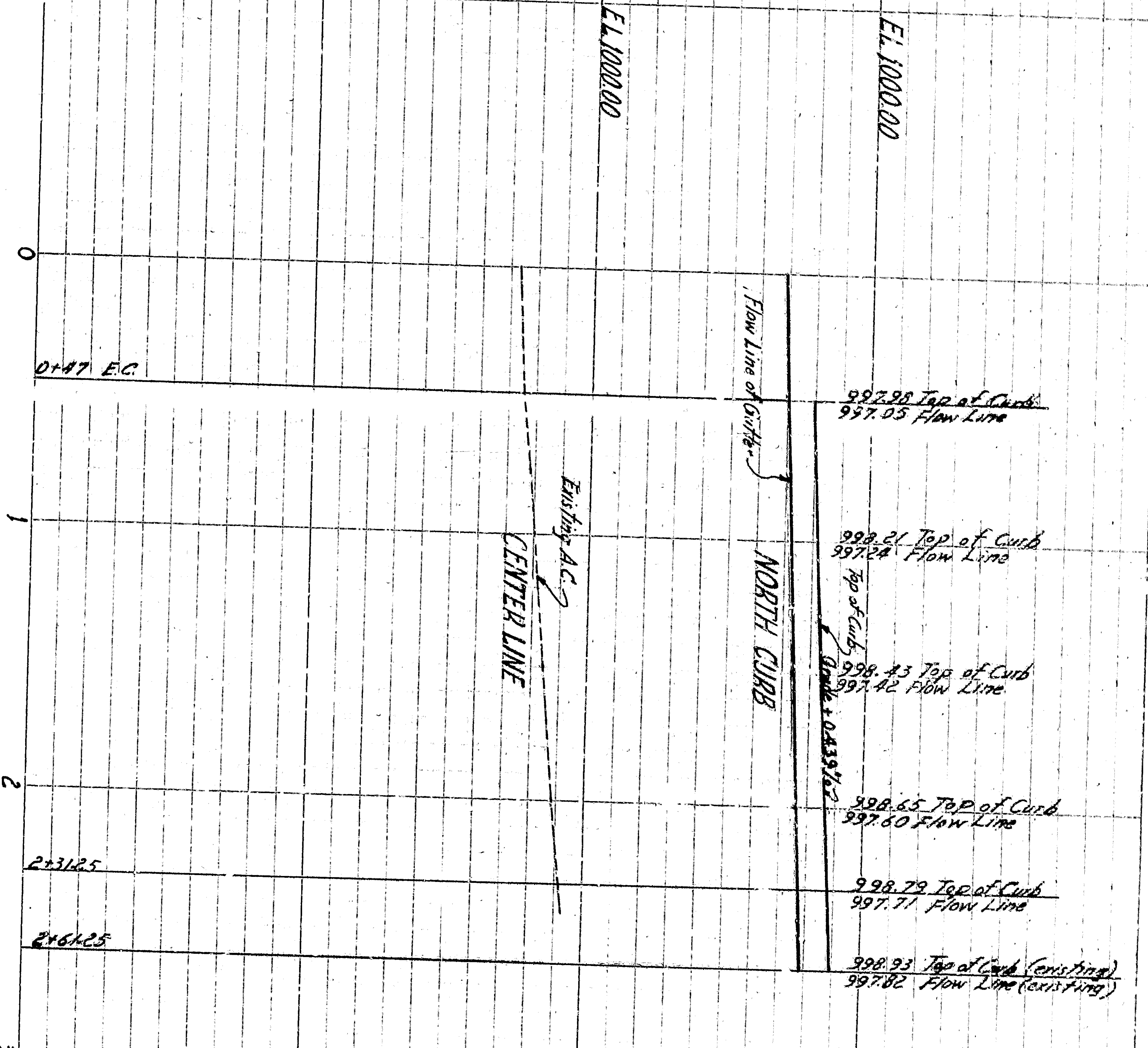
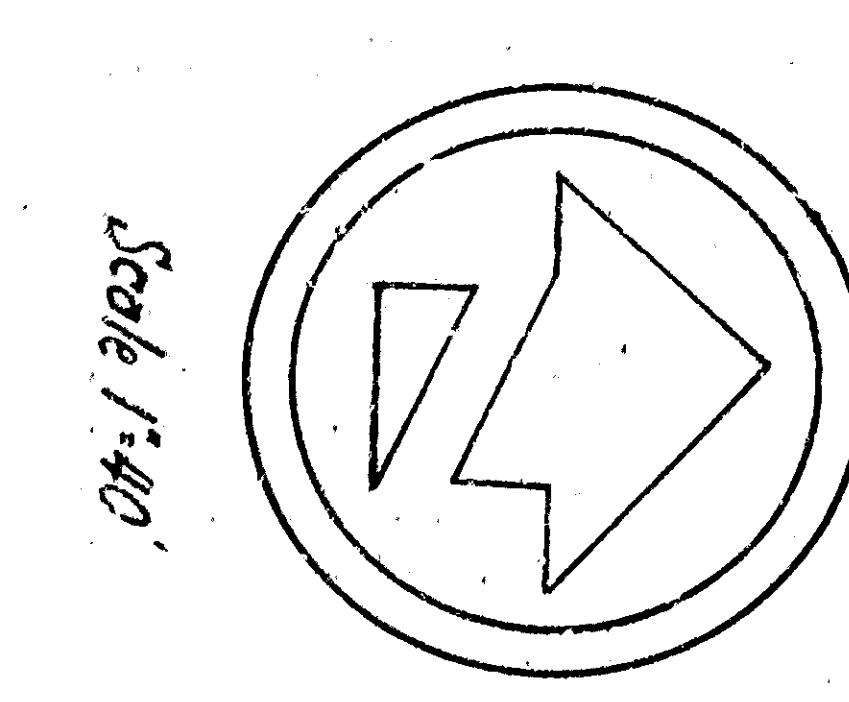
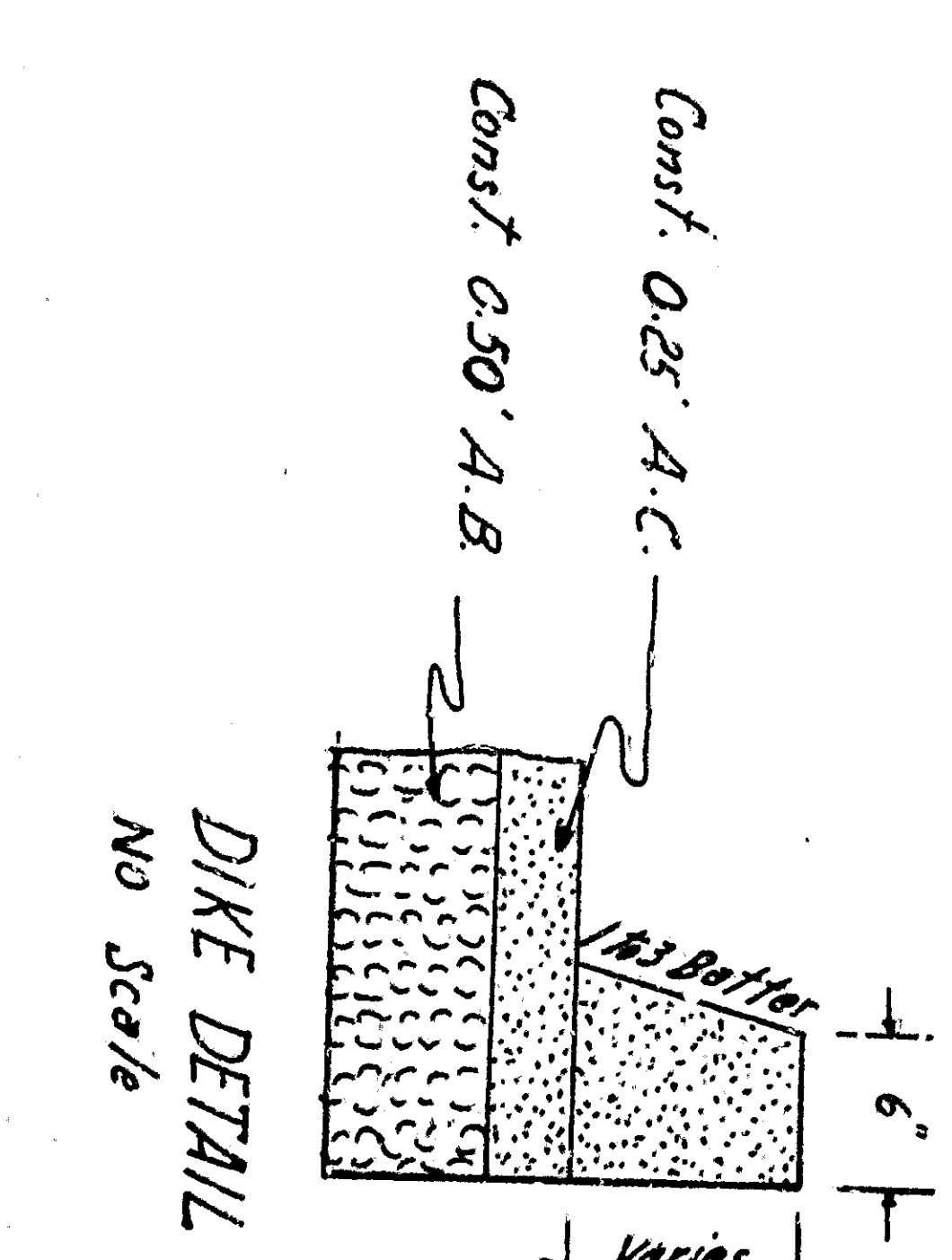
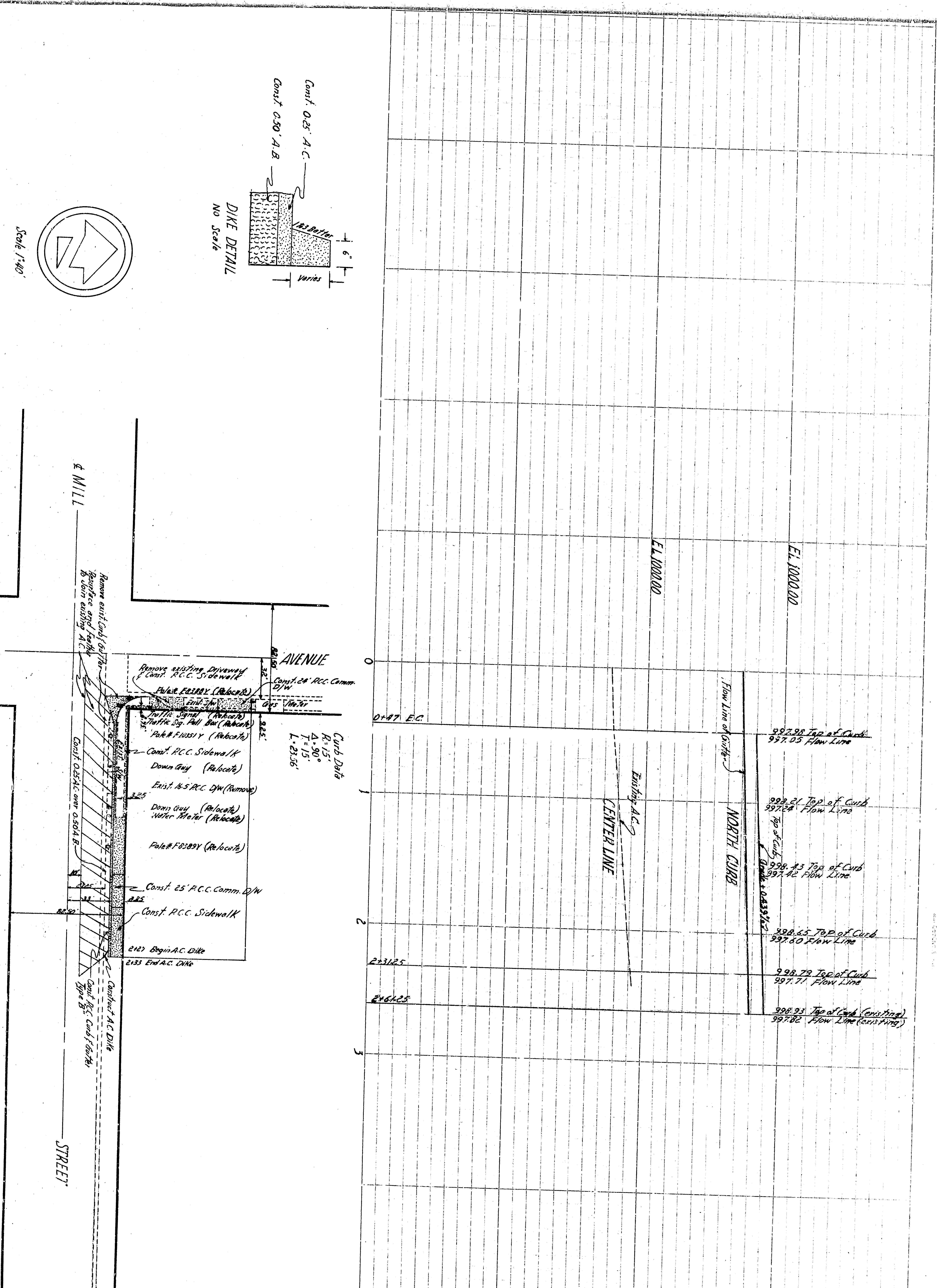

**GENERAL NOTES**  
 1. All work embodied on this plan shall be in conformity with applicable provisions of Standard Specifications No. 2232, 2233, 2234, 2235, 2236 and Standard Drawing No. 2231 as filed in the Office of the City Engineer.  
 2. Bench Mark  
 Center Line of Mill St. and Arrowhead Ave.  
 E.L. 997.55 M.S.L.

APPROVED	DATE	1942
REGISTERED CIVIL ENGINEER NO. 42551		
DRAWING NO. 3309	DRAWN BY	
SHEET 1 OF 1	CHECKED BY	
1 SHEET	RECOMMENDED BY	
DEPARTMENT OF ENGINEERING CITY OF SAN BERNARDINO <b>IMPROVEMENT PLAN</b> Northwest Corner of Mill St. and Arrowhead Ave.		